

A.M.06 Banheiro com Vestiário para Func. Fem.  
Escala: 1:25

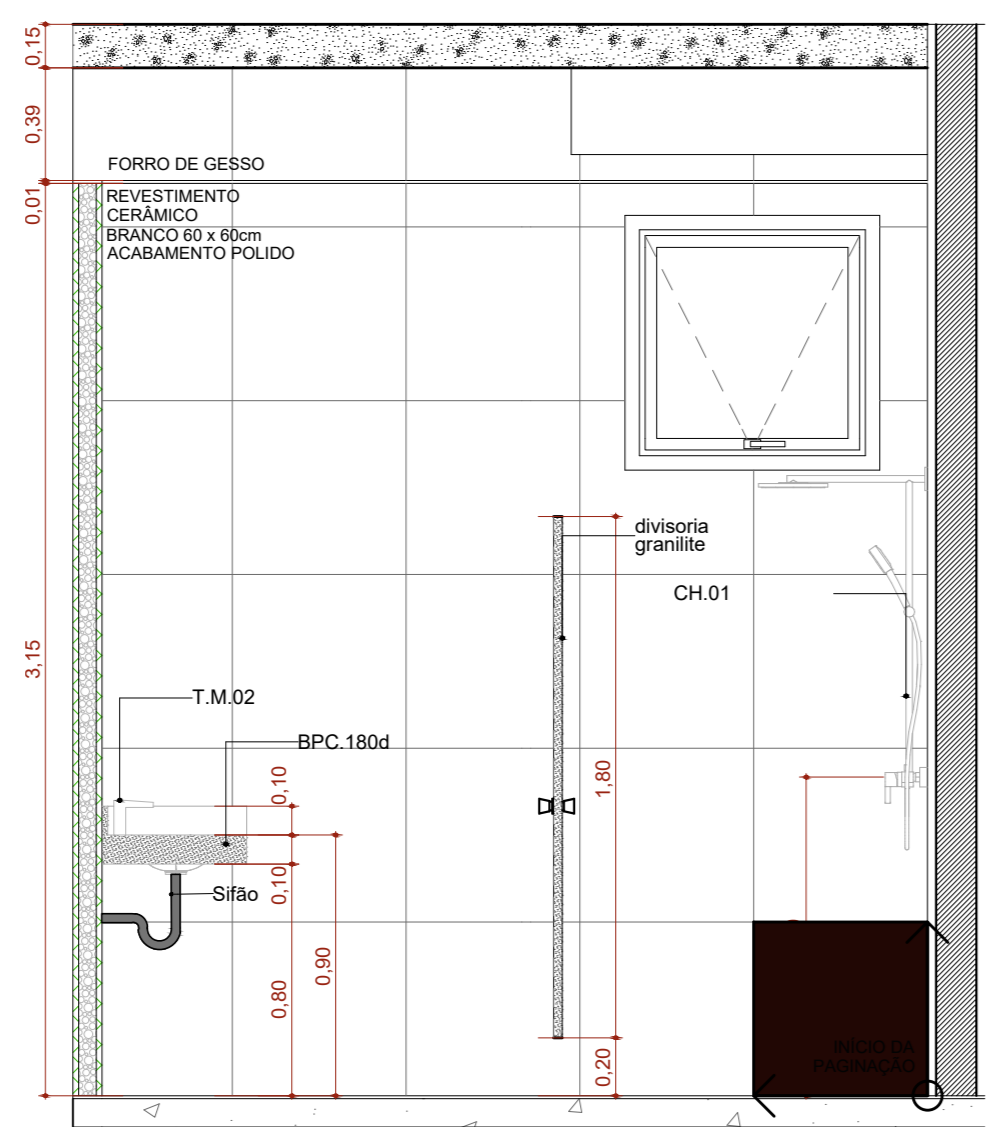

A.M.06 VISTA 01  
Escala: 1:25

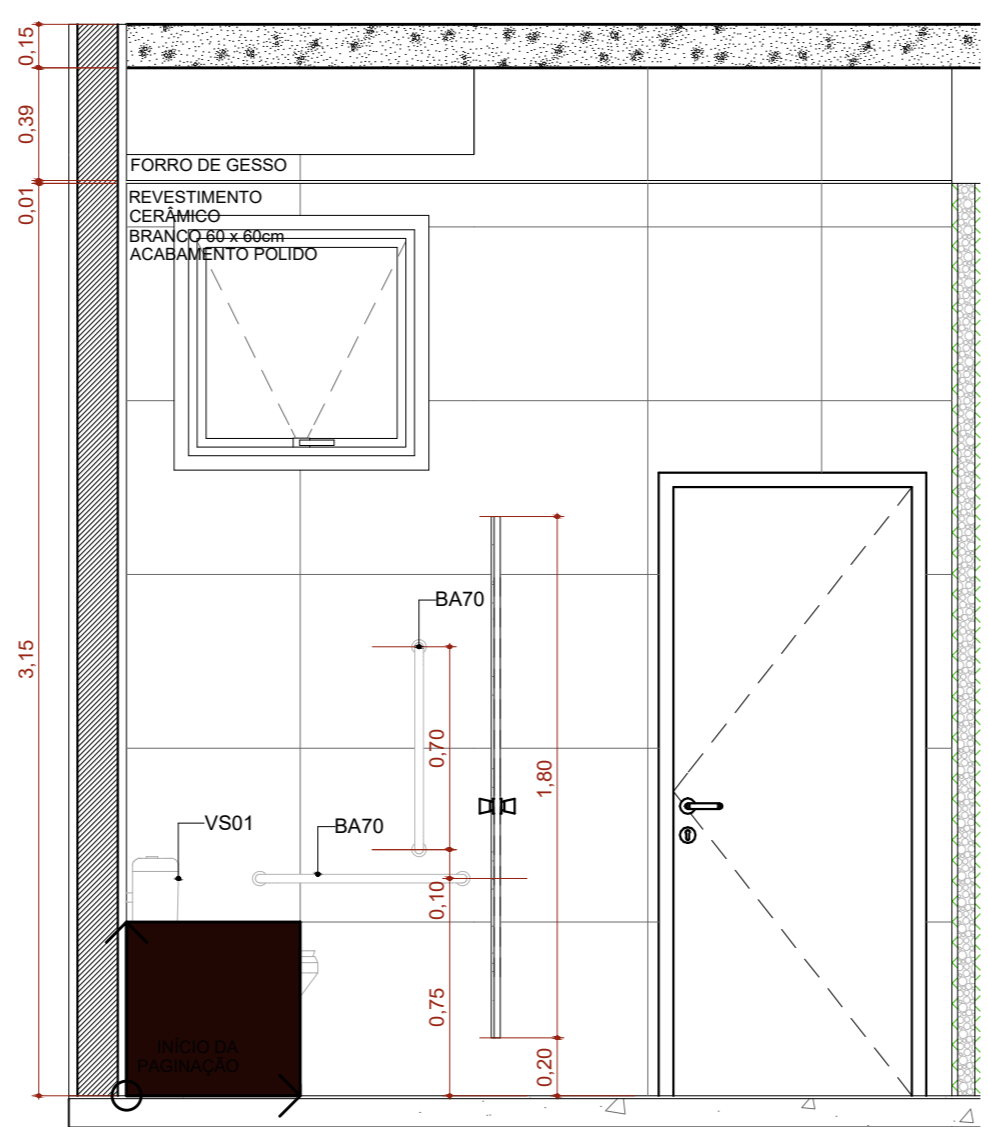

A.M.06 VISTA 02  
Escala: 1:25

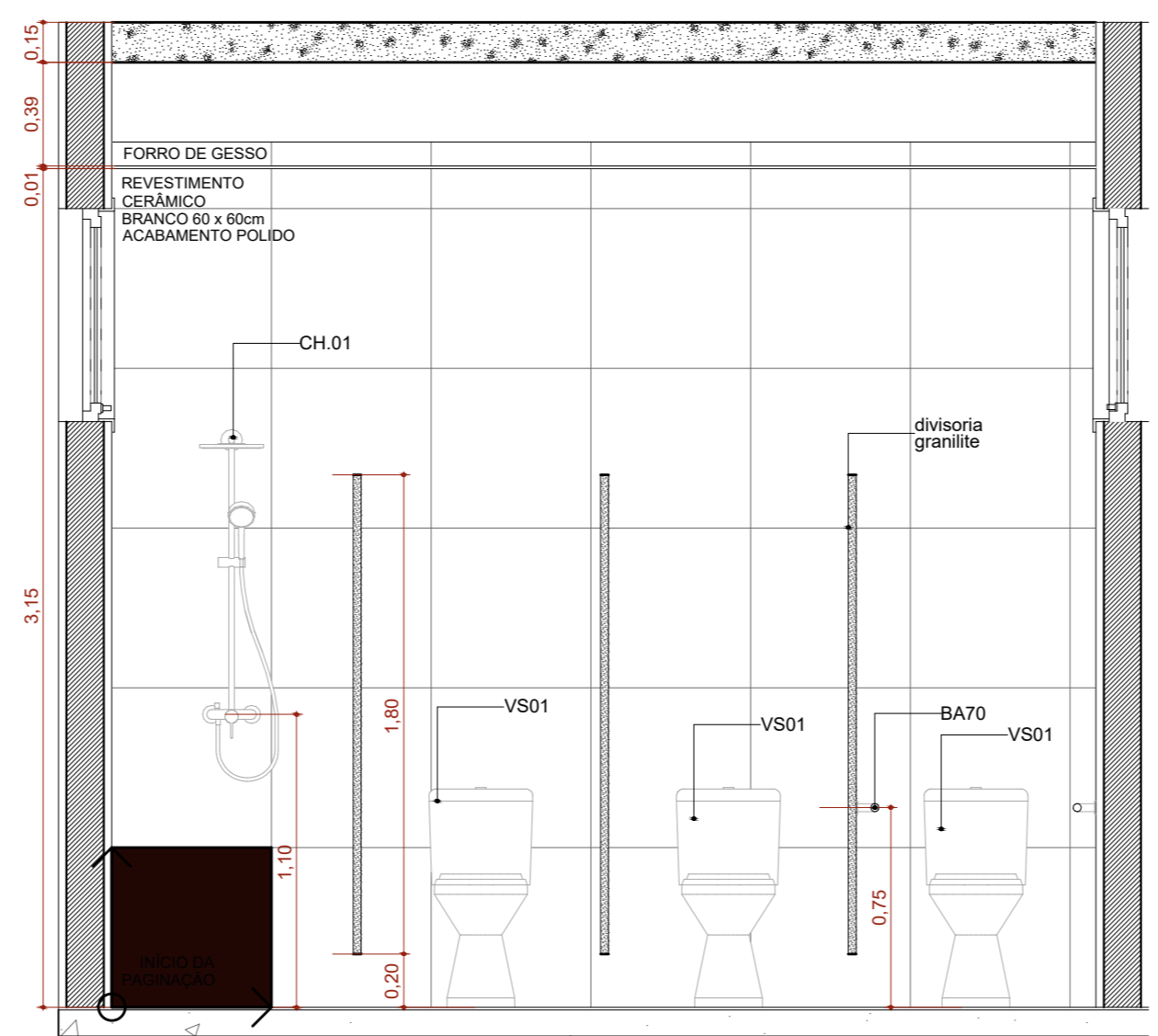

A.M.06 VISTA 03  
Escala: 1:25

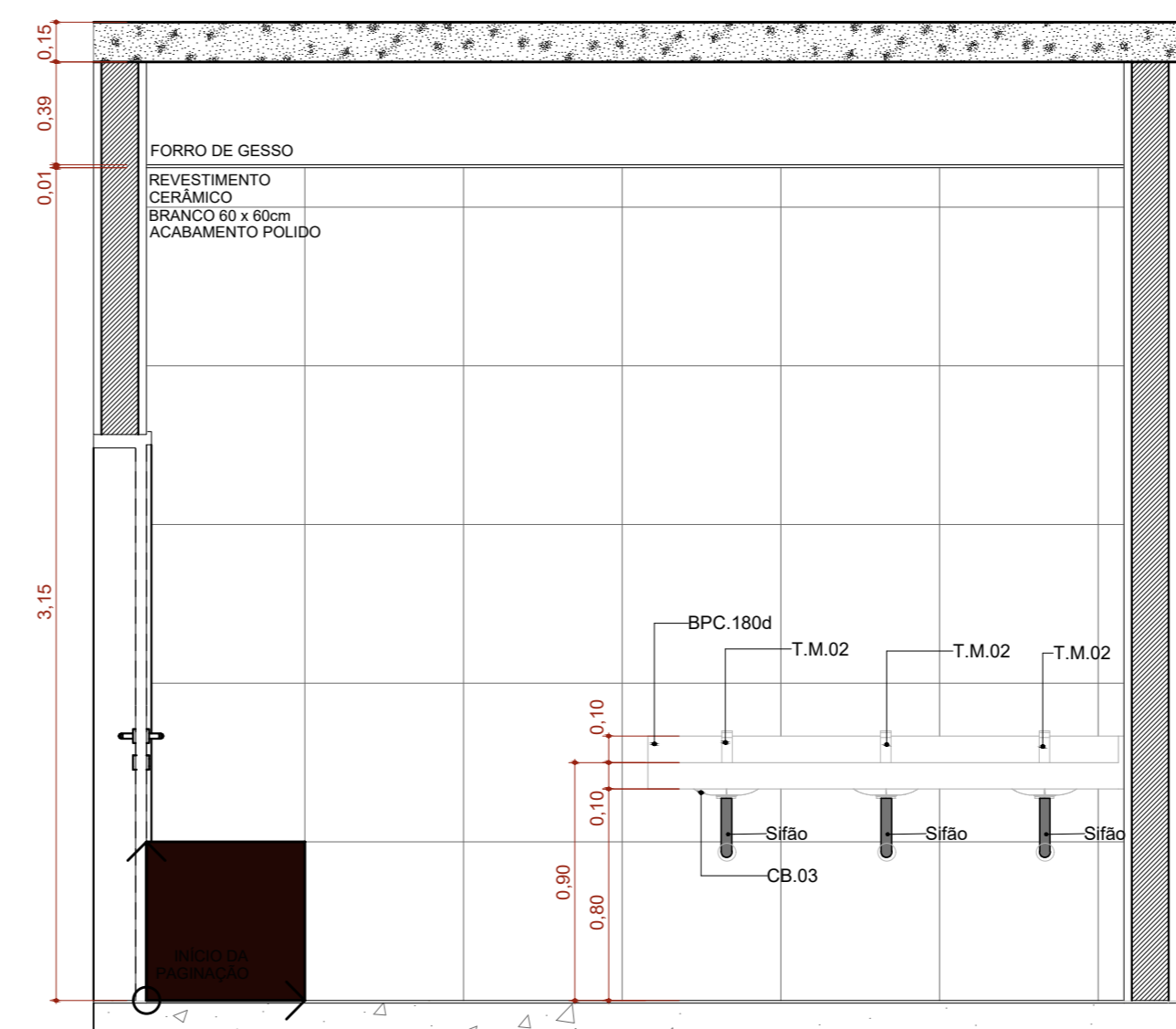

A.M.06 VISTA 04  
Escala: 1:25

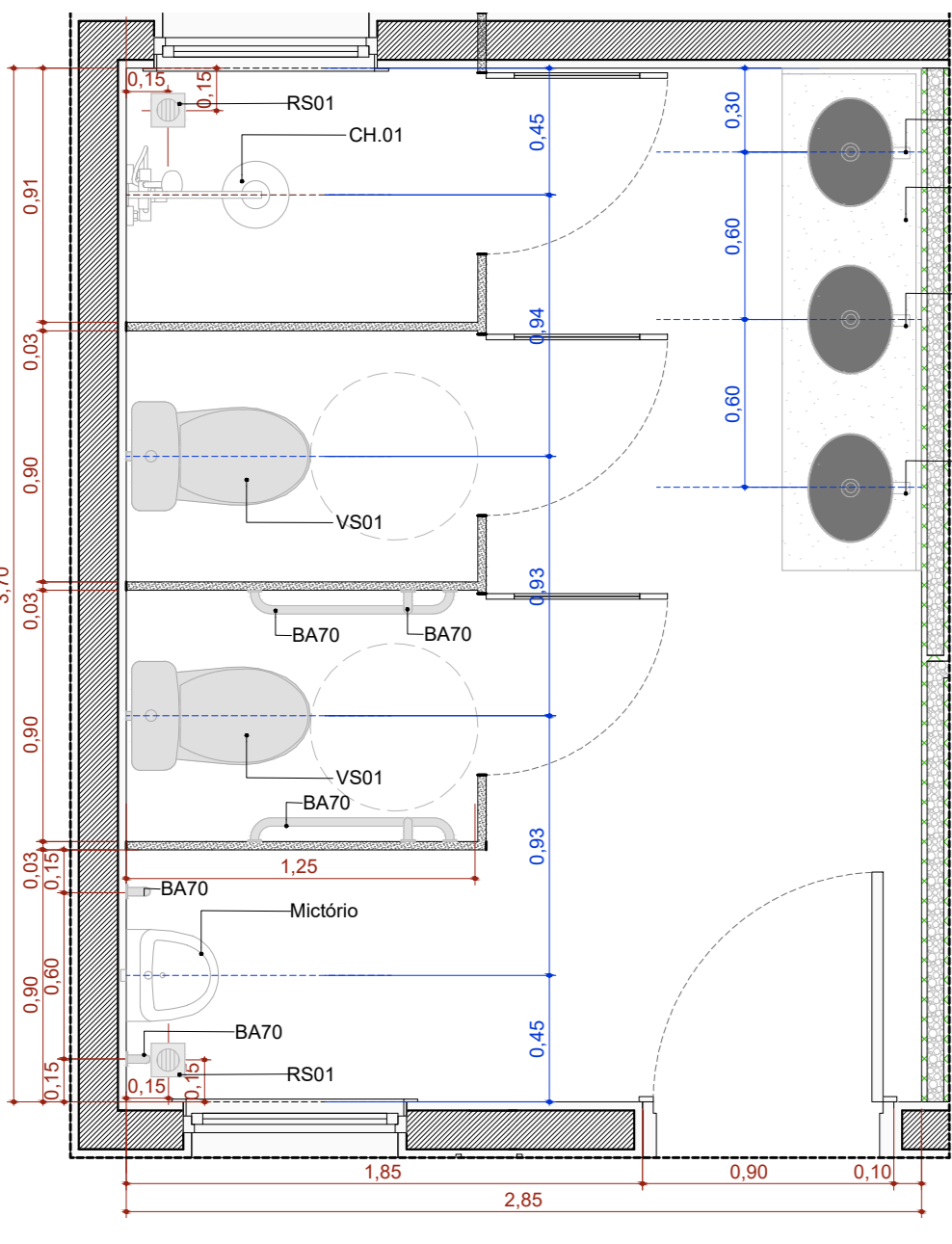

A.M.07 Banheiro com Vestiário para Func. Masc.  
Escala: 1:25

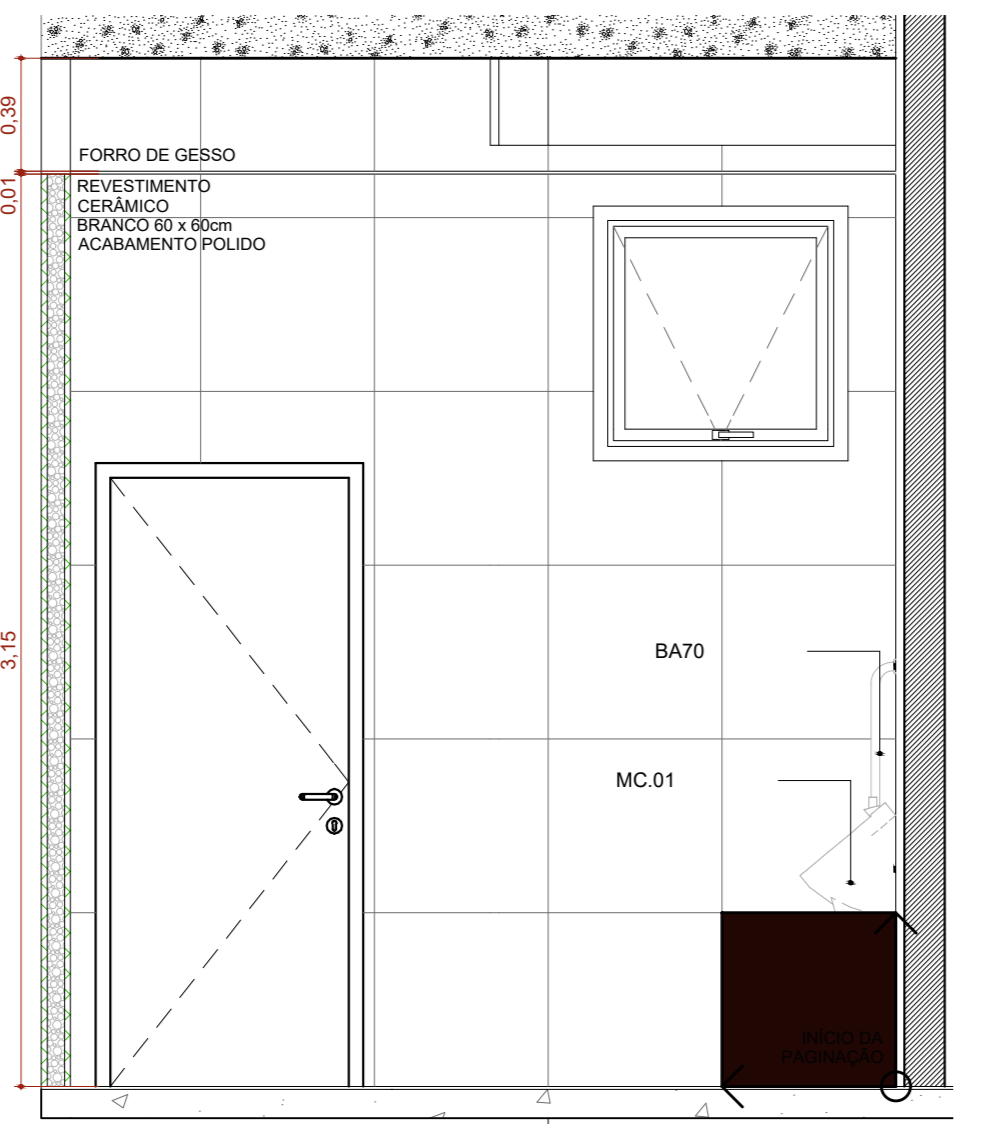

A.M.07 VISTA 01  
Escala: 1:25

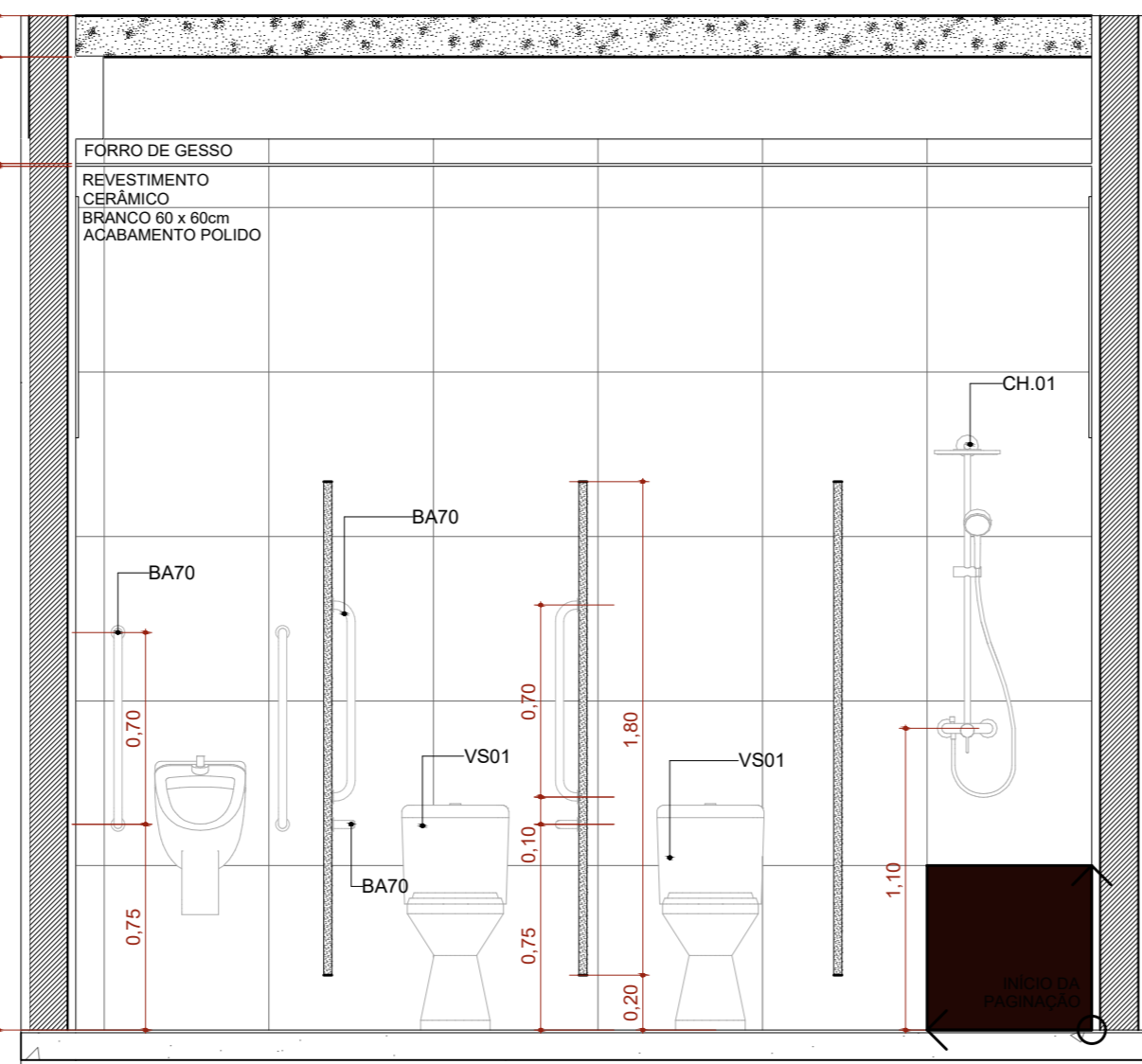

A.M.07 VISTA 02  
Escala: 1:25

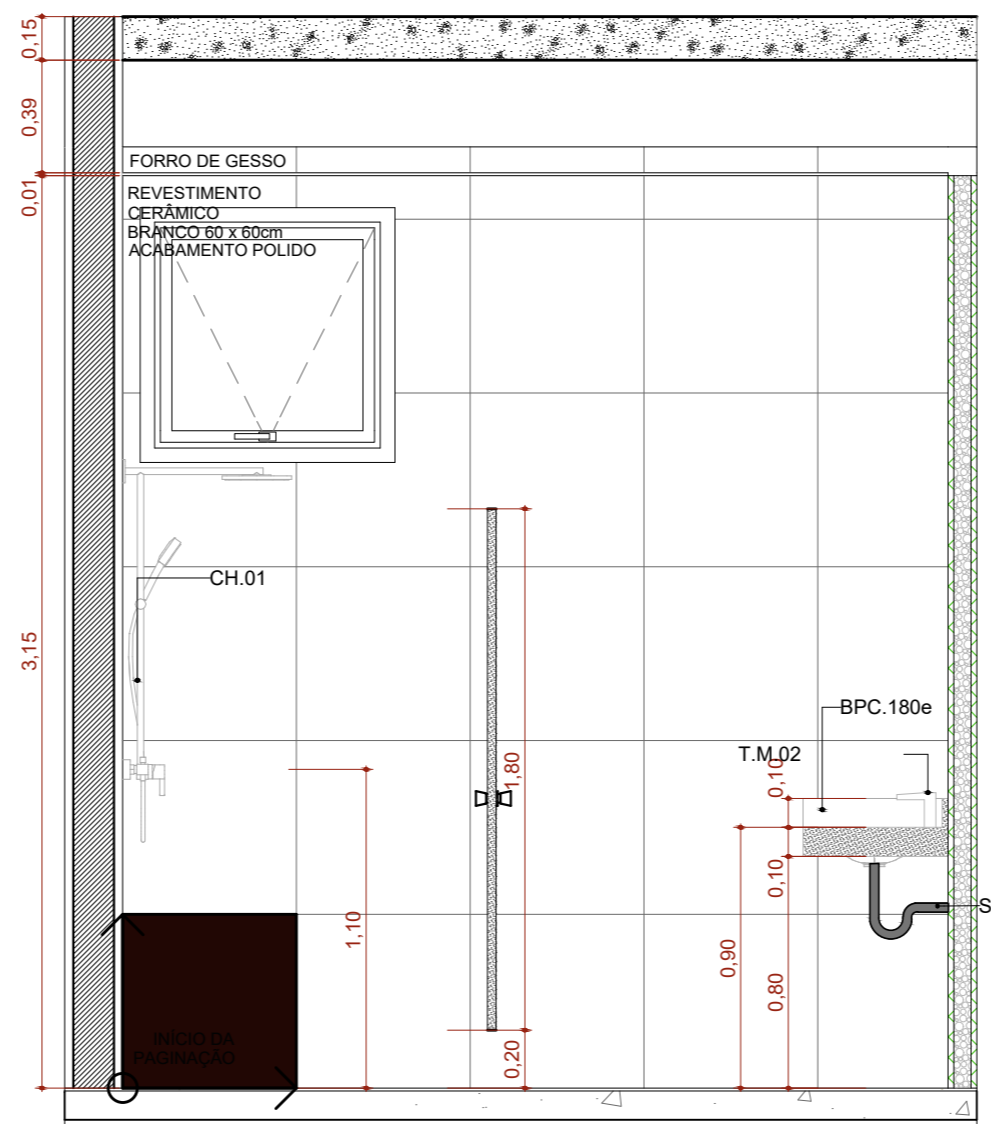

A.M.07 VISTA 03  
Escala: 1:25

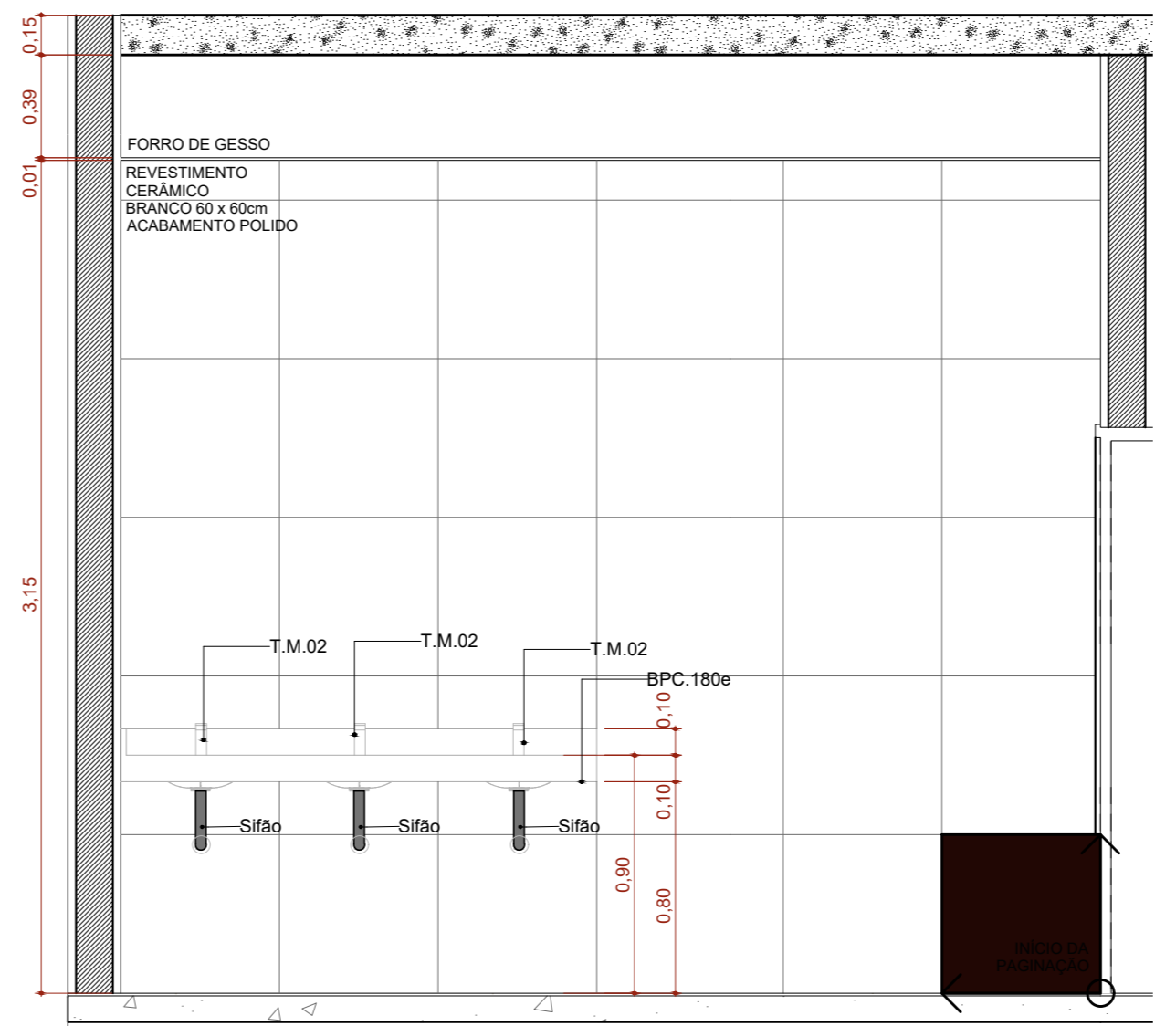

A.M.07 VISTA 04  
Escala: 1:25

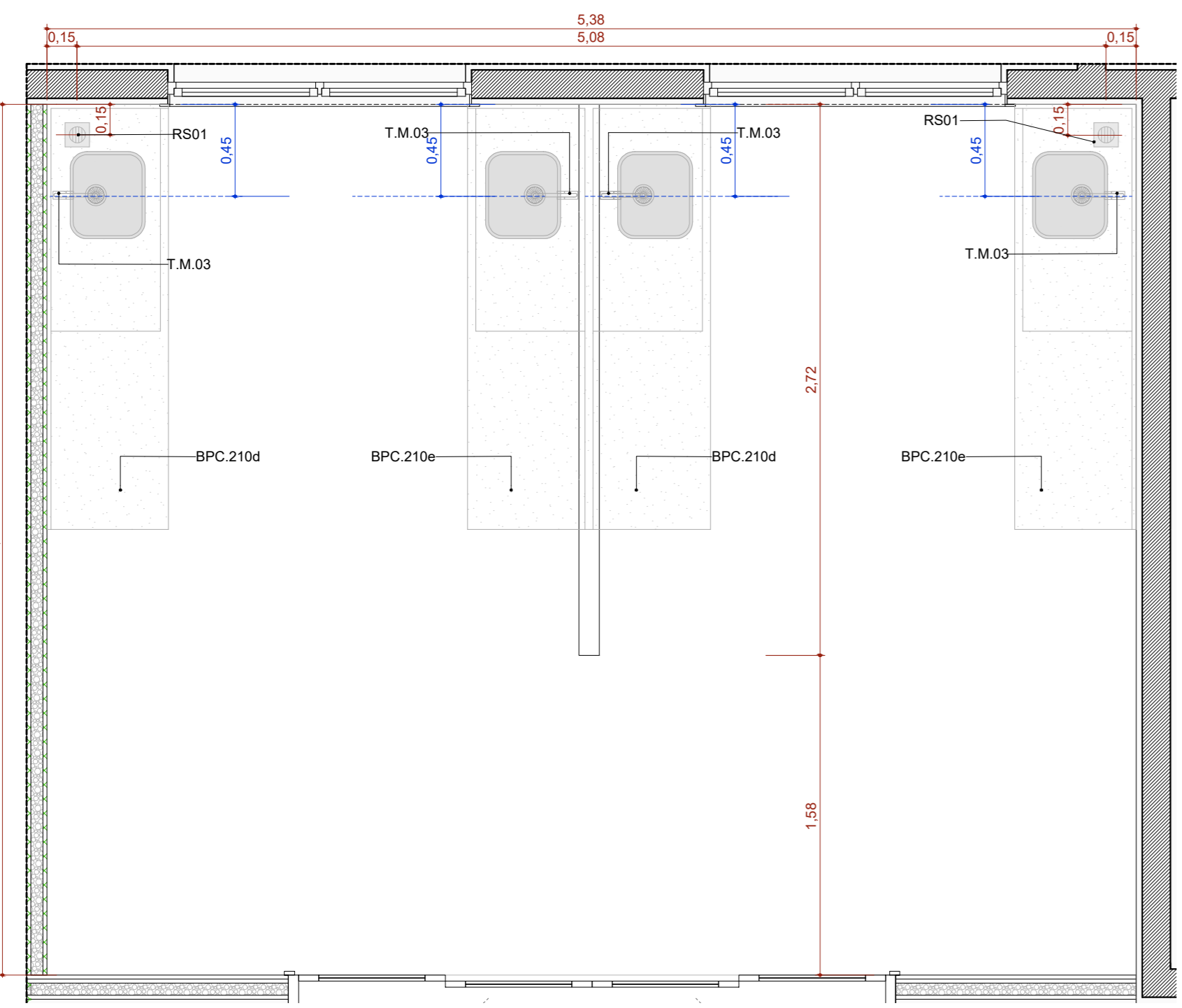

A.M.08 Cozinha  
Escala: 1:25

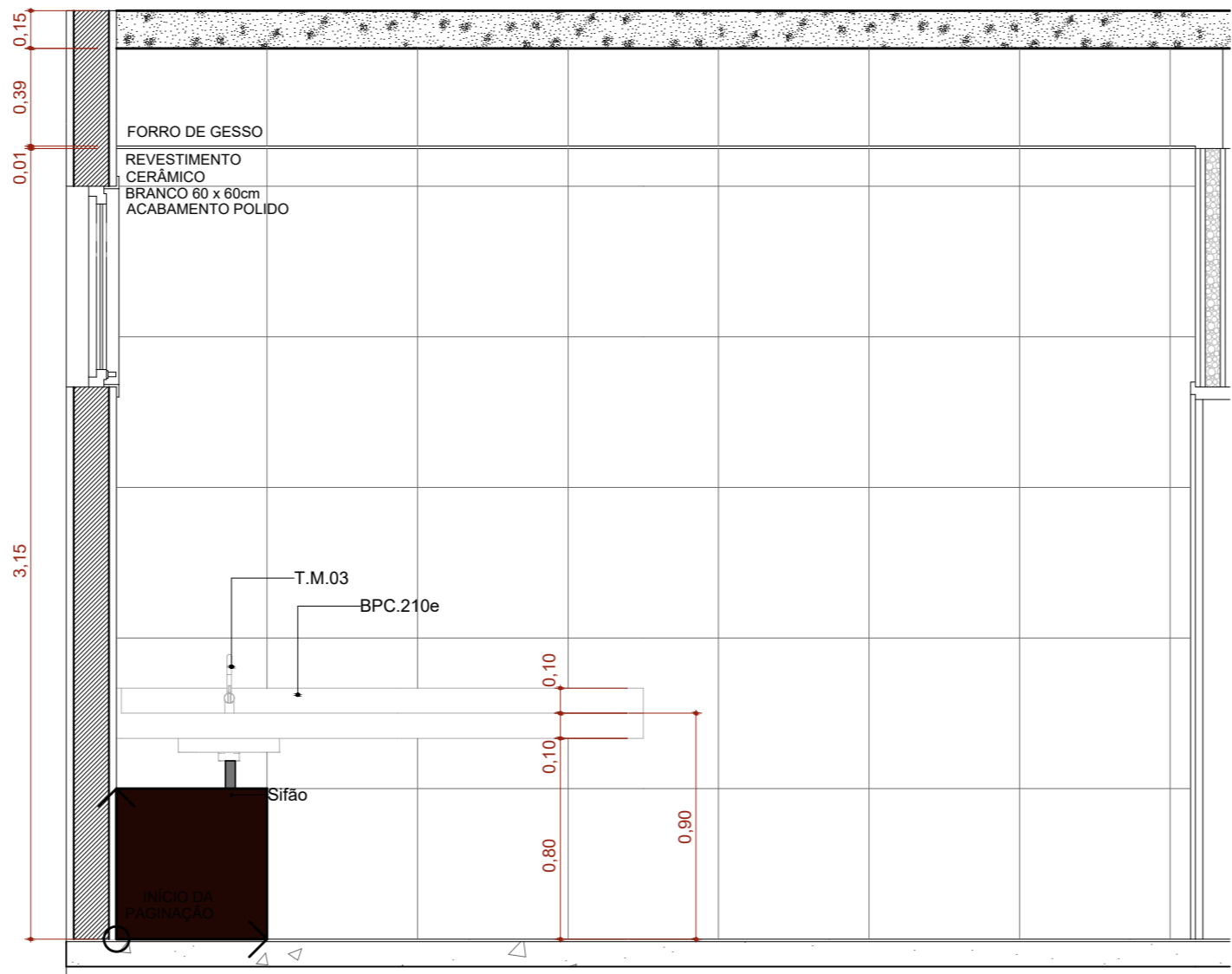

A.M.08 VISTA 01  
Escala: 1:25

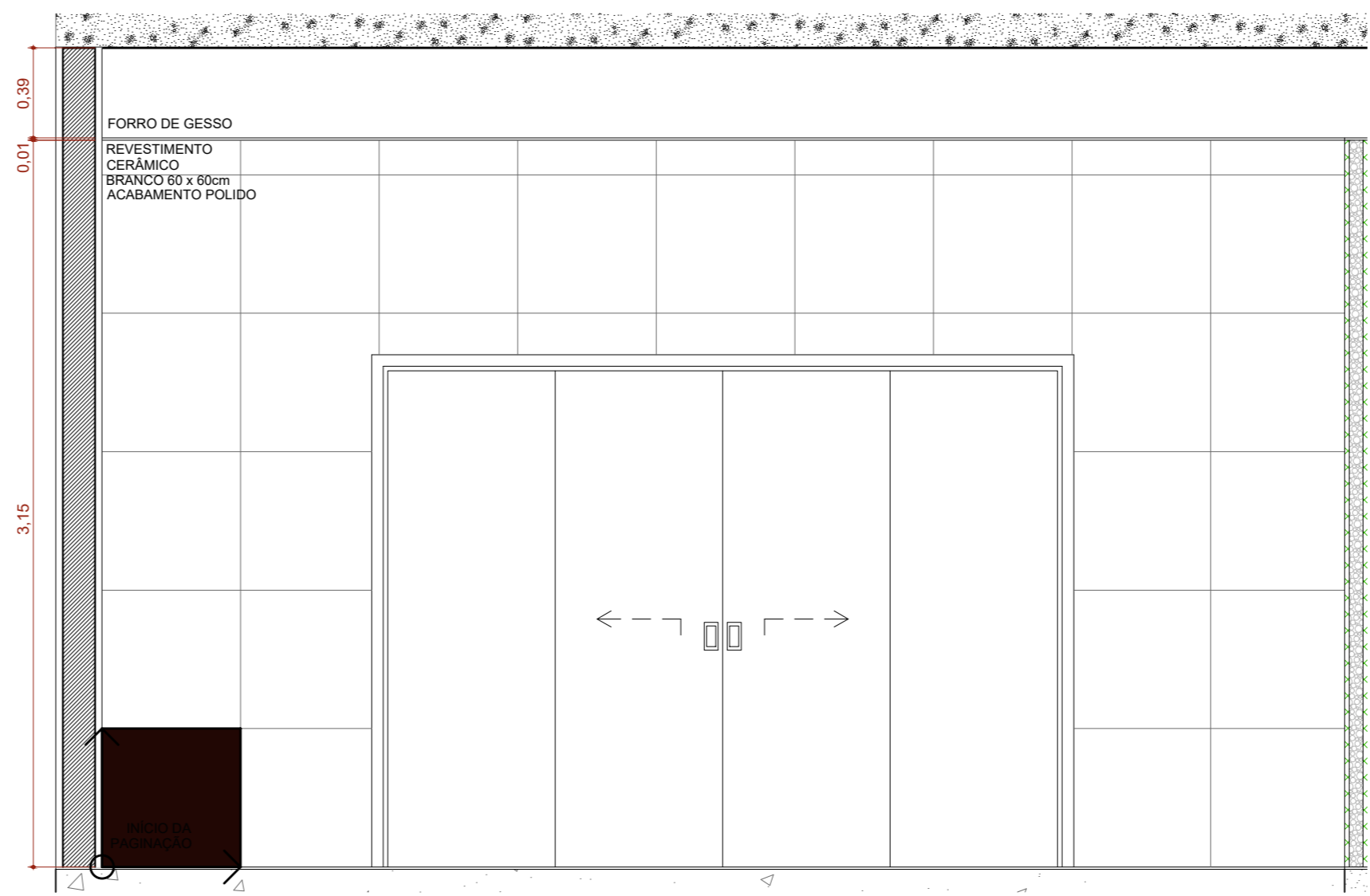

A.M.08 VISTA 02  
Escala: 1:25

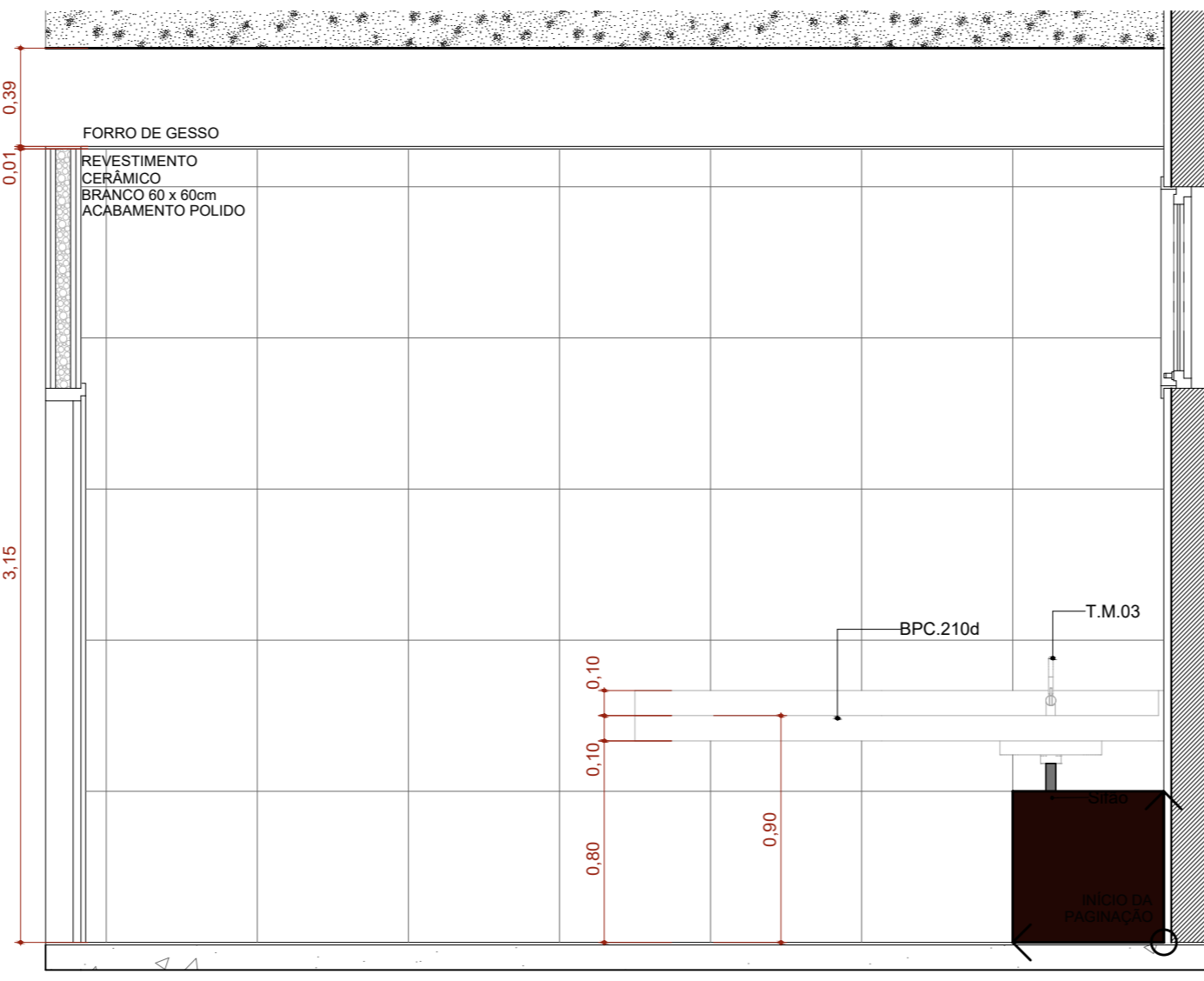

A.M.08 VISTA 03  
Escala: 1:25

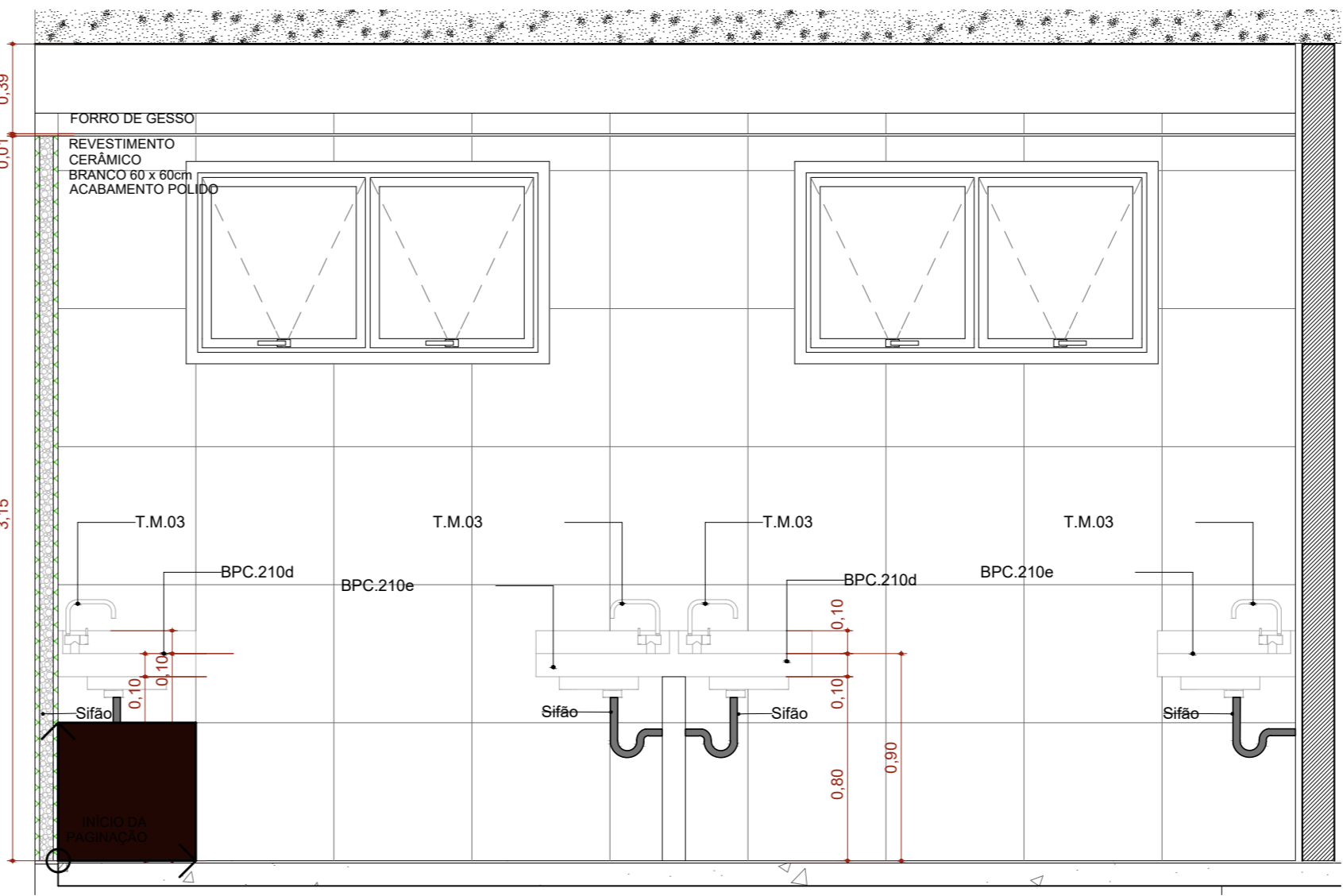

A.M.08 VISTA 04  
Escala: 1:25

AUTOR(A) DO PROJETO EXECUTIVO		REGISTRO	
ALEXANDRE BERTRAM ROSA - ARQUITETO E URBANISTA		CAU - A 37618-3	
TÍTULO DO PROJETO			
CENTRO DE ATENÇÃO PSICOSSOCIAL I e II			
PROPRIETÁRIO			
MINISTÉRIO DA SAÚDE			
SECRETARIA DE ATENÇÃO ESPECIALIZADA À SAÚDE			
CNPJ			
00.394.544/0109-03			
PROCESSO			
Secretaria de Atenção Especializada à Saúde			
Esplanada dos Ministérios Bloco G Edifício Sede - Ministério da Saúde			
CEP 70.668-900 - Brasília- DF			
TÍTULO DA FASE			
DETALHAMENTO ÁREAS MOLHADAS 02			
DESCRIÇÃO DA ETAPA			
PROJETO REFERENCIAL CONCEITUAL			
NOME: PRONÓIA - ANEXO V	REVISÃO	UNIDADE	DATA
CAPS I e II, FL. 13.14	R01	METROS	09/05/2025
MIRELA P. PESSATTI	A 25662-5	ESCALA	
VICTÓRIA ANGELI GAVOVIŁLA	A 247156-6	INDICADA	
LEONARDO MEGIATO PEREIRA DOS SANTOS	A 188776-8	17,00 x 40	
DANIEL NAROLLI SANTOS	A 62348-6	118,89 x 84,16	
AUTORIA INTELLECTUAL			
DIREITOS AUTORAIS RESERVADOS CONFORME LEGISLAÇÃO NACIONAL E INTERNACIONAL			