

1 Térreo
1: 75

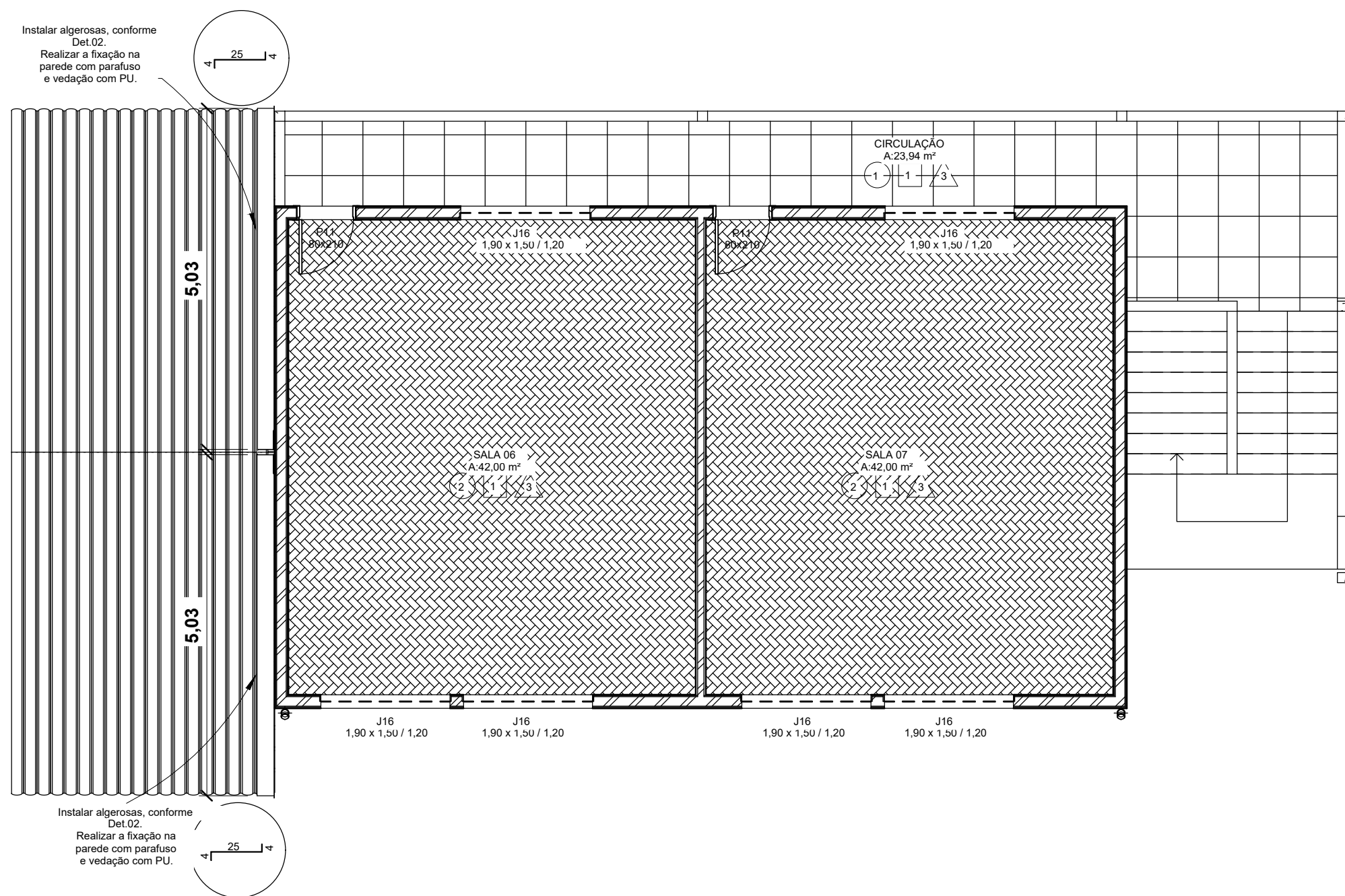

2 2º Pavimento
1: 75

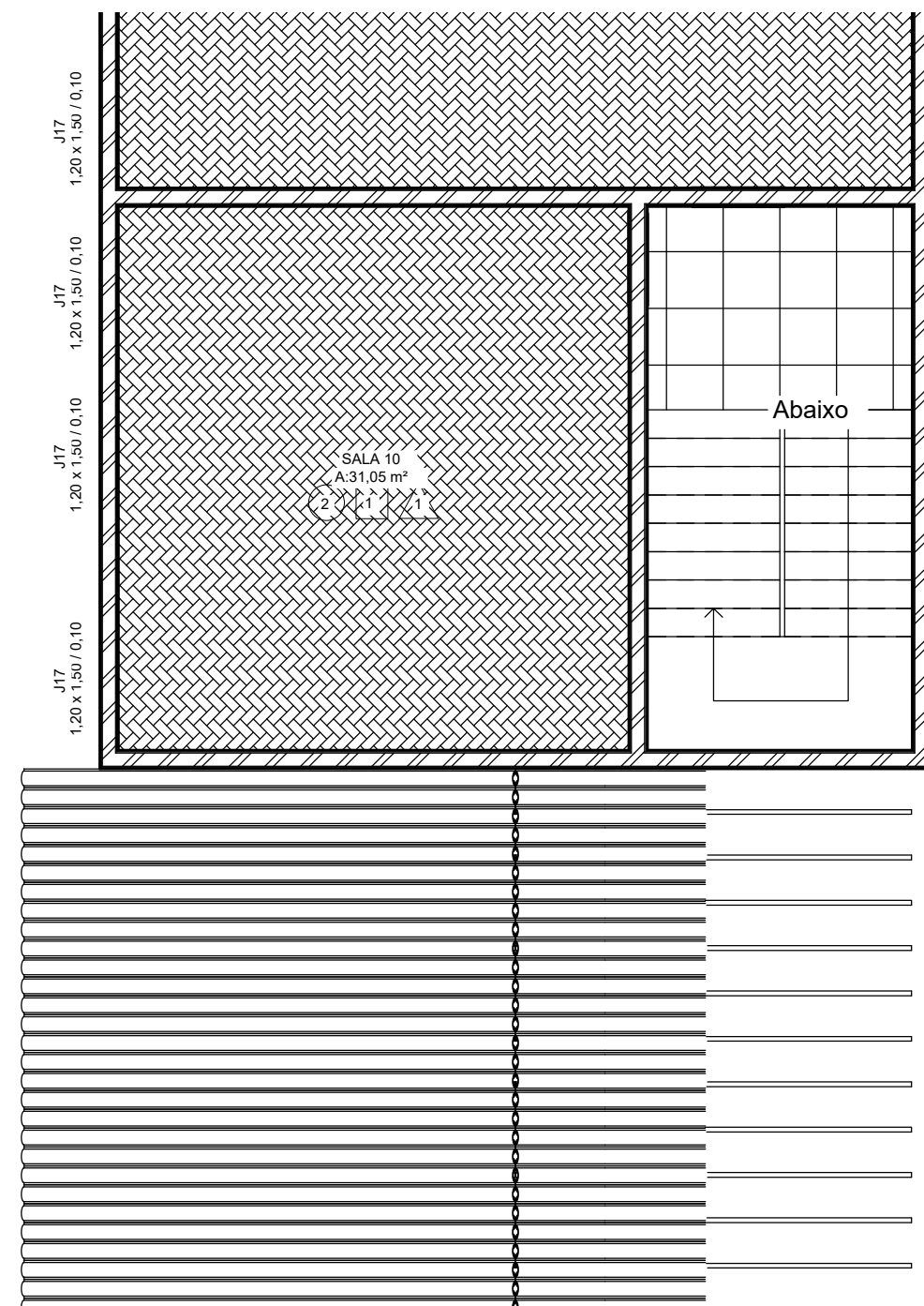

G Corte G-G
1: 50

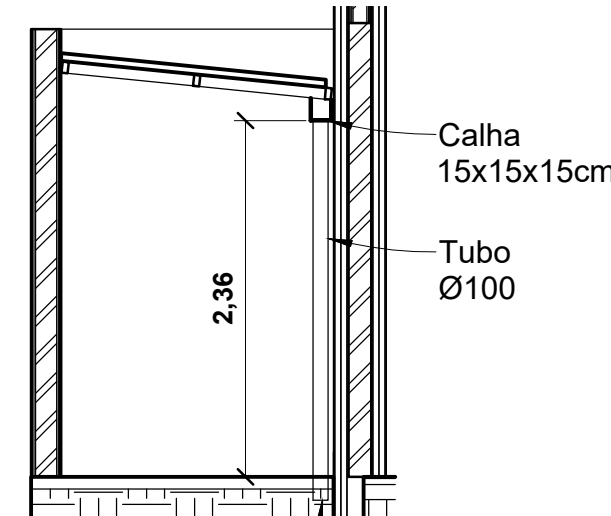

H Corte H-H
1: 50

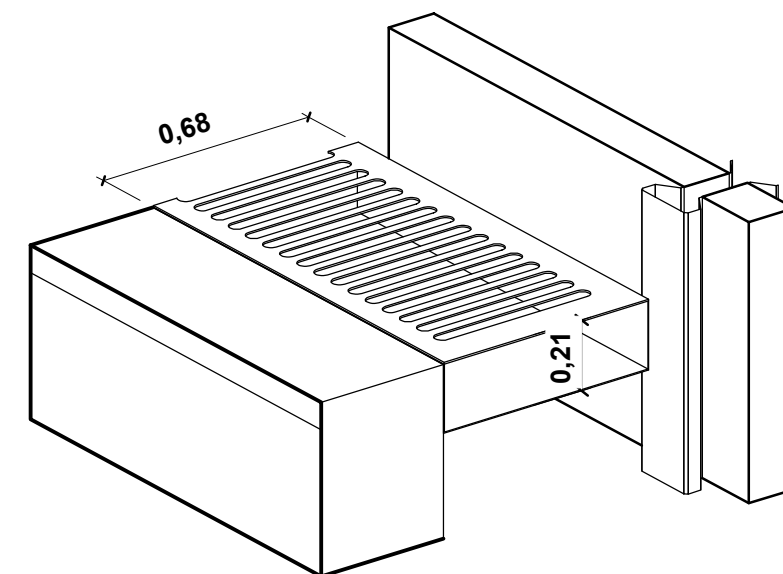

3 Det.03

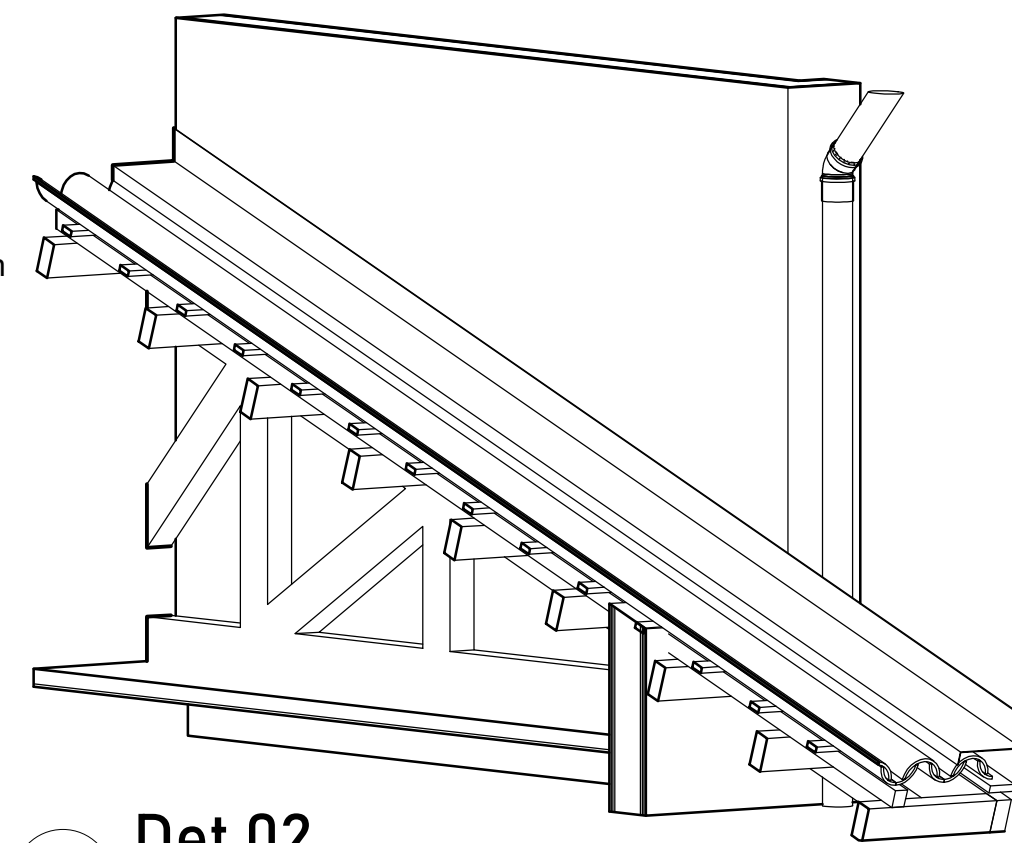

4 Det.02

Projeto:	Proprietário:
PROJETOS E CONSULTORIA	JNICÍPIO DE CAMPO BOM
Documento assinado digitalmente DORLI PEREIRA DA SILVA Data: 06/03/2024 17:47:09-0300 Verifique em: https://validar.br.gov.br	
Eng. Civil Dorli Pereira da Silva CREA/RS 13.035	
PROJETO PLUVIAL	
PLANTAS BAIXAS - DETALHES	
Arquivo:	Prancha:
10/01/22	PL01
EMEF SANTOS DUMONT	1.864,68m²
Projeto:	Cliente:
EMEF SANTOS DUMONT	MUNICÍPIO DE CAMPO BOM
Endereço:	Tipo:
Rua 17 de abril, 543, Imigrante, Campo Bom- RS	Ampliação Escolar